



INDUSTRIAL UNIT TO LET

- 📍 Size: 4,807 sq ft (446.58 sq m)
- 📍 Rent: £13 psf + VAT pa
- 📍 Rateable Value: £51,000
- 📍 Rates Payable: £26,112
- 📍 Service Charge: £4,807 +VAT pa
- 📍 EPC Rating: D (93)

A well presented trade counter unit with a large warehouse benefitting from a purpose built ground floor showroom and first floor offices.

Reform Trade Park consists of 4 units that were comprehensively refurbished & upgraded in 2018.

There is a large car park to the front with ample room for parking and loading. Specification includes, electric roller shutter door, loading bay, warehouse (with cooling), ground floor showroom, first floor offices and 3 phase power.

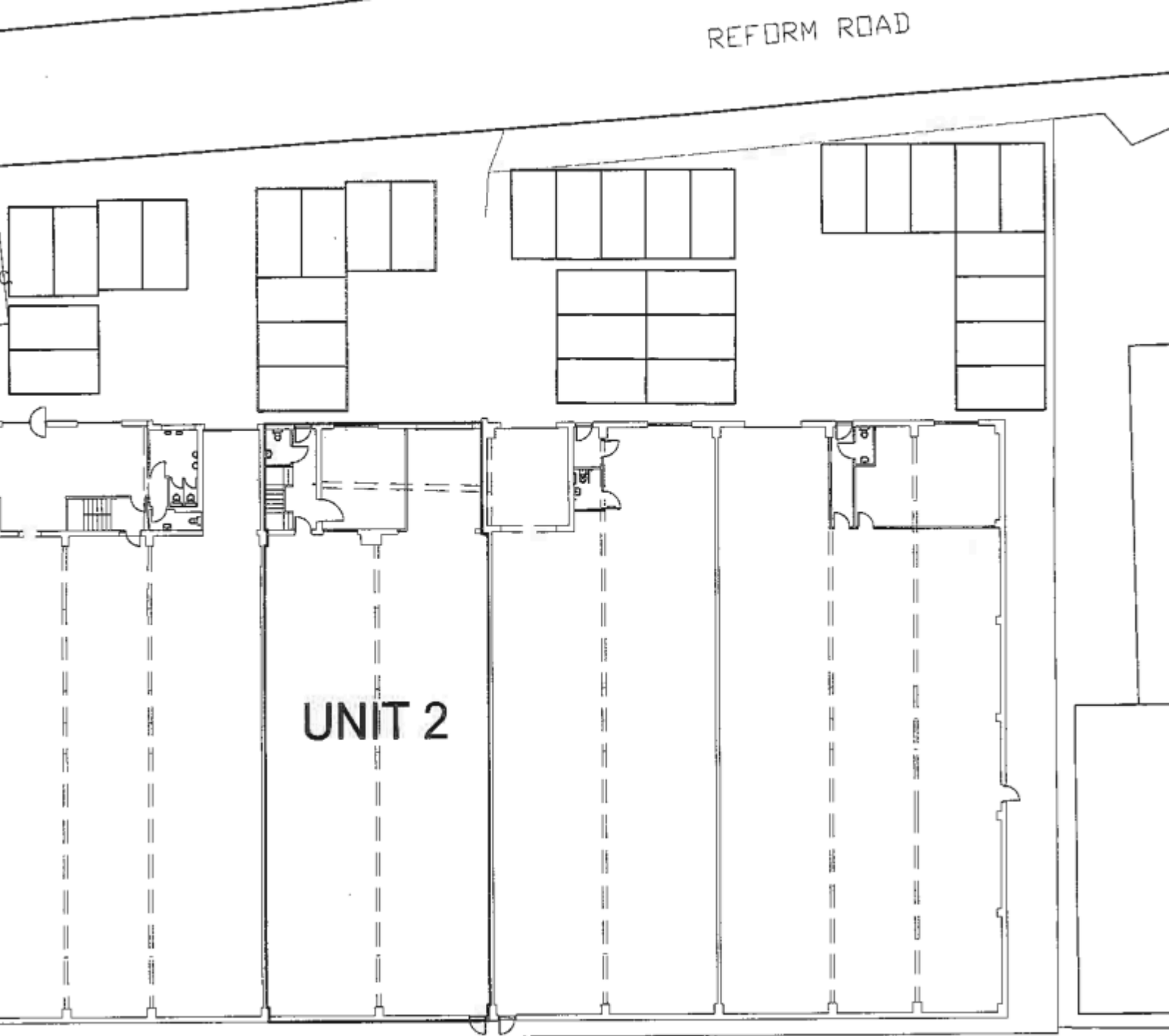

UNIT 2, REFORM TRADE PARK, REFORM ROAD, MAIDENHEAD, SL6 8BY

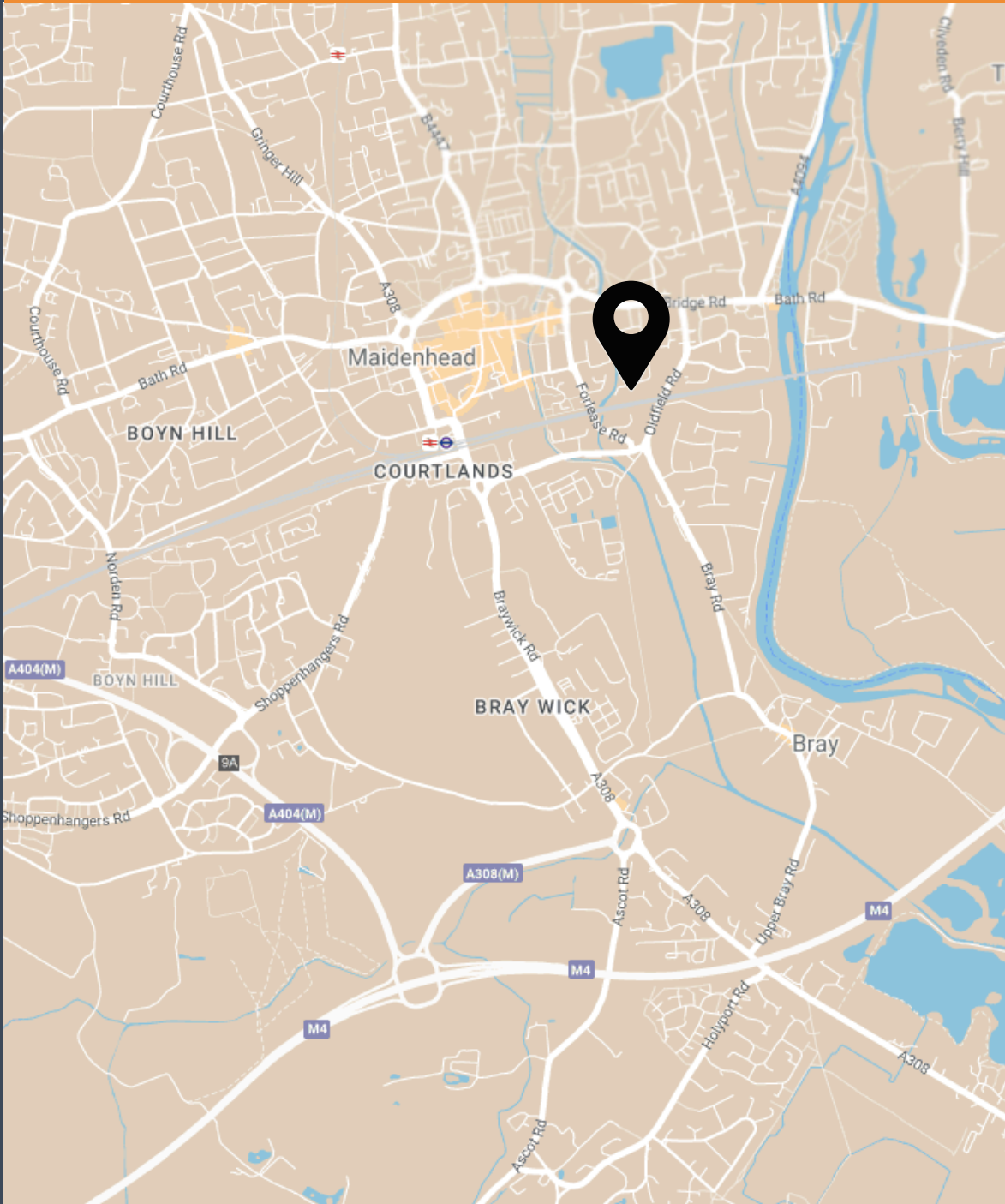

**3 MILES TO M4
(J8/9)**



**1 MILE TO
MAIDENHEAD
TRAIN STATION**



**13 MILES TO
HEATHROW
AIRPORT**



MARK HARRIS

Page Hardy Harris

01628 367439 | 07598450586
mark@pagehardyharris.co.uk

SOPHIE HOLMES

Page Hardy Harris

01628439006 | 07763 565056
sophie@pagehardyharris.co.uk

Misrepresentation clause. These particulars are set out as a general outline only for the guidance of intending purchasers or lessees and do not constitute the whole or any part of an offer or contract. The information is compiled and given in good faith but without any responsibility whatsoever. Intending purchasers or tenants should not rely on them as statements or representations of fact. August 2024.

